



## PRODUCT OVERVIEW

# 18



solution control system

บริษัท ชเลเกิ้ล อิเล็กทรอนิกส์คอนแทค (ไทยแลนด์) จำกัด



[Managing Director]  
Mr. Banhan Sangfasuwan  
คุณ บรรหาร แสงฟ้าสุวรรณ

☎ 081- 904 -9749

☎ 02-889-3747-8

☎ 095-249-8798

🌐 [slgthailand.com](http://slgthailand.com)

✉ [mr.banhan888@gmail.com](mailto:mr.banhan888@gmail.com)  
[schlegelthaiweb@gmail.com](mailto:schlegelthaiweb@gmail.com)

Louder &  
Brighter  
since 1910.

66/36 หมู่ 4 ต.ศาลายา อ.พุทธมณฑล จ.นครปฐม 73170  
66/36 Moo 4, Salaya, Phutthamonthon  
Nakhonpathom 73170

# Louder & Brighter since 1910.

Since 1910, our driving force has been our desire to use exceptional engineering ingenuity to develop superior technical equipment that is a step ahead of the rest. This desire is now stronger than ever.

Although we are a medium-sized company, we have huge ambitions. As an owner-run family company, trust and compassion are at the heart of all we do.

Here at Auer Signal, we are passionate about upholding the image we have created for ourselves, working to the motto 'louder & brighter since 1910'.

## A milestone in the history of signalling

In 2018, we are living up to our reputation as a leading player in the world of signalling by launching a very special product. Our new signal tower marks the latest milestone in the history of signal towers. The name of our new product sums up its capabilities: it is called Modul Perfect 70, or PC7 for short.

How can we be so confident in our new tower that we are calling it "perfect"? Because it is. In terms of creative design, performance, application options and future-proofing, it simply could not be better.

## The Modul Perfect 70

The perfect light modules of the PC7 are up to 6 times brighter than comparable signal towers; 7 positions ensure maximum flexibility; our new diffuser films enable 2 different visual appearances; an even brighter top light module extends the application spectrum even further; alongside the perfect LED steady light beacon modules, we can also provide multi colour, rotating light and multi function options; the multi-tone module is now also available as an inline module; the new multi-tone alarm sounder module guarantees maximum tone quality and variety; the innovative MP3/voice output module can play back a huge range of audio formats and, last but not least, our patented M12 base enables a cost-effective M12 connection.

All of these functions can be provided with only 70 article numbers.

All of this makes the new Modul Perfect 70 signal tower exactly what it claims to be: nothing but perfect.

Ihr Christian Auer



# Seven compelling reasons to choose Auer Signal

# 1

## **WE DEVELOP OUR OWN PRODUCTS AND PRODUCTION IS COMPLETED TO THE HIGHEST OF INDUSTRIAL STANDARDS**

All of the development work for our products is taken care of in-house – from the initial planning to the design stage.

We are most proud of our electronic development, with state-of-the-art industrial machines in use for production and innovative IT solutions ensuring that our production processes are continually optimised.

Thorough and detailed testing enables us to achieve optimum quality. We are particularly proud of our performance in electronic development.

# 2

## **EVERY PRODUCT WE CREATE IS OF EXCEPTIONAL QUALITY**

We only use premium materials in our production processes and polycarbonate is one of our key resources, as it is impact-proof, UV-resistant and colour-fast.

We always ensure that our visual signalling equipment has an intelligent lens design and features state-of-the-art LED technology. To meet the highest of demands for signalling, we supply products with the most effective high-power LEDs available.

Our modular signal towers are created with the utmost precision, helping our company to stand out from the crowd by offering innovative detailed solutions. Audible signalling equipment from Auer Signal is among the loudest on the market.

# 3

## **WE HAVE PRODUCTS FOR EVERY APPLICATION - RANGING FROM THE PREMIUM TO THE VALUE SEGMENT**

Our extensive product portfolio covers all of the requirements across our signalling equipment markets. As well as our high-end equipment, our range also includes some exciting products with an excellent price-performance ratio.

We offer our customers an extensive product portfolio that is tailored to specifications.

From automation technology, mechanical and plant engineering and building technology to the chemical and petrochemical sectors, safety applications and even uses under extreme conditions, we serve all sectors and branches of industry.

# 4

## **WE DEVELOP AND PRODUCE TAILOR-MADE SIGNALLING EQUIPMENT**

Our ability to listen teamed with our engineers' passion for developing new products and special solutions to suit specific requirements has been key to our success.

With products being fully developed in-house, adjustments being made in line with a customer's own product design, and special wiring options and types of mounting, we are confident that we are the number one partner when it comes to implementing any customer requirements that are specific to them or their sector.

# 5

## **OUR SIGNALLING EQUIPMENT COMPLIES WITH THE REQUIRED INDUSTRY STANDARDS FOR USE AROUND THE WORLD**

We live and breathe quality and safety standards. Plus, as Auer Signal is an international company, our signalling equipment is globally approved and can be used all around the world.

UL, EAC, CE, ATEX and ISO certifications make up the most important marks and safety standards for Auer signalling equipment.



# 7

## **WE ALWAYS DELIVER ON TIME**

We have an excellent record when it comes to delivering on time, meeting our deadlines in 99.7% of cases, working to a just-in-time supply system. Keeping our delivery promises belongs to our traditions and ensures that our customers are very satisfied and loyal.

# 6

## **WE KEEP OUR PROMISES (AND HAVE BEEN DOING SO SINCE 1910)**

Auer Signal is an owner-run family company in its fourth generation.

We are a well-established company that has been a reliable partner for more than 100 years now.

For all of our customers and partners, our unwavering trustworthiness is a convincing selling point that they have come to value highly.

We have a dedicated team of highly skilled employees who are friendly and personable as they work quickly to see to our customers' every wish and desire. This is reflected in the international business relationships we have built up on trust and reliability, which are still standing after decades.

# Masterpieces of Engineering

Signalling equipment  
for every application

From high-end products to  
the best value for money



**BLG**

Cost-effective LED flashing  
beacon for general  
applications



**QBL**

High-power LED signal beacon  
with three flash patterns: for  
applications that require  
extreme brightness.

At Auer Signal, you will find a complete product range of high-quality signalling equipment. In the optical signalling equipment range you can choose between an LED signal beacon from our premium Q series or a cost-effective LED flashing beacon from our G series, for example.

Where the beacons in the Q series have been designed with high-power LEDs and three flash patterns for very high frontal and lateral signalling effect in extreme applications, the beacons in the G series are suitable for straightforward general applications.

## Our material of choice: polycarbonate

Polycarbonate: the material we  
use for our signalling equipment



High-quality polycarbonate has many advantages: it is impact-resistant, vandal-proof, temperature-resistant, colour-fast and UV-stabilised. Our lenses are available in six different colours.

## A diverse array of mounting types

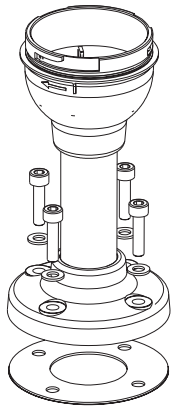

Every mounting type is possible

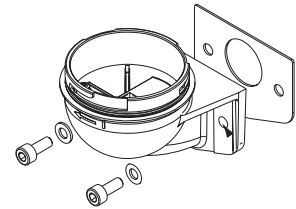
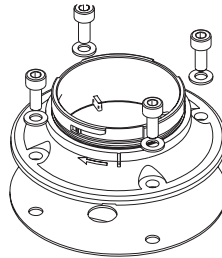
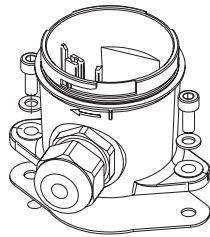
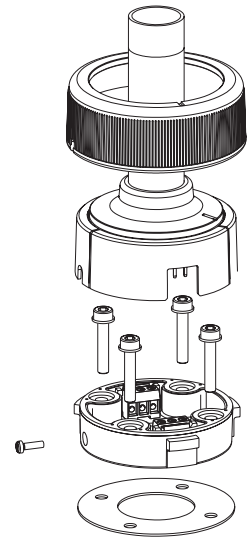

We have the right mounting solution for every application, regardless of how the signalling device is mounted. Be it horizontally, vertically, on a wall, on a pipe or magnetically.

## Connections made easy

Well-thought-out connection technology saves time and money



Our well-thought-out connection technology helps you to save time, hassle and money. Convenient connection options such as push-in or clamping yoke technology guarantee high contact reliability.

## High-power LED – the strongest LED



High Power LED  
by Auer Signal

Alongside the standard LEDs, Auer Signal also offers high-power LEDs or high-performance beacons which provide exceptional brightness and maximum light output. There is no brighter LED on the market.

## The loudest multi- tone alarm sounder with 127 dB

ASX — the Mighty

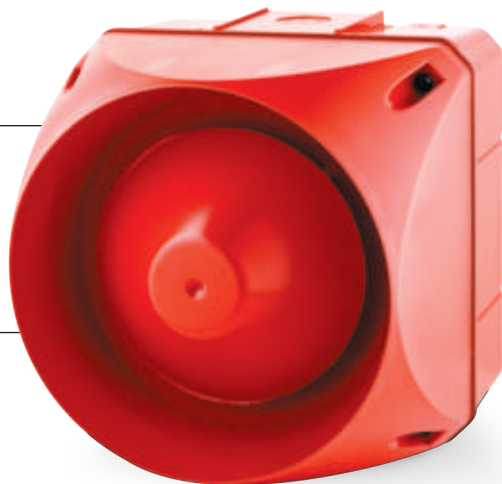

The sounder with sound pressure of 127 dB.  
The loudest siren currently available.



## Built for extremes

Serie P — the Tough



Fully sealed signal beacon with high degree of protection for extreme areas of application in dust, ice, rain or heat. Best signalling effect thanks to modern LED and xenon technology.



## The ultimate M22 signalling equipment series

A complete product range in 3 sizes



Auer Signal provides the most extensive M22 panel mount signalling equipment series. Available in three sizes with the loudest panel mount buzzer currently available.



## An engineering masterpiece



Modular signal tower system with bayonet locking

Our modular signal towers are produced with unrivalled precision; the signal modules boast the lowest tolerance levels. Developed and built for many years of problem-free use in the industry.

## The smallest modular signal tower



With a diameter of 40 mm, our ECOModul40 series is the smallest modular signal tower series available anywhere in the world. It is the only member of the ECOModul series to be equipped with an LED multi strobe or multi colour strobe.

## All sizes available

We produce signal towers for every application and in every common size: Ø 30 mm, Ø 40 mm, Ø 50 mm, Ø 60 mm and Ø 70 mm.

Signal towers  
in all sizes





# PC7 – Modul Perfect 70

Nothing but perfect

## FEATURES

- Up to 6 times brighter than comparable signal towers
- 7 positions provide maximum flexibility
- Two visual appearances available with the new diffuser
- Even brighter top light module with hemispherical signalling effect
- New LED light modules with multi colour, rotating light, multi function and steady light functions
- Multi-tone module now also available as an inline module
- New multi-tone alarm sounder module for the best possible tone quality and variety
- Innovative MP3/voice output module for playing back audio formats
- Patented, cost-effective M12 bases

# Up to 6 times brighter than the competition

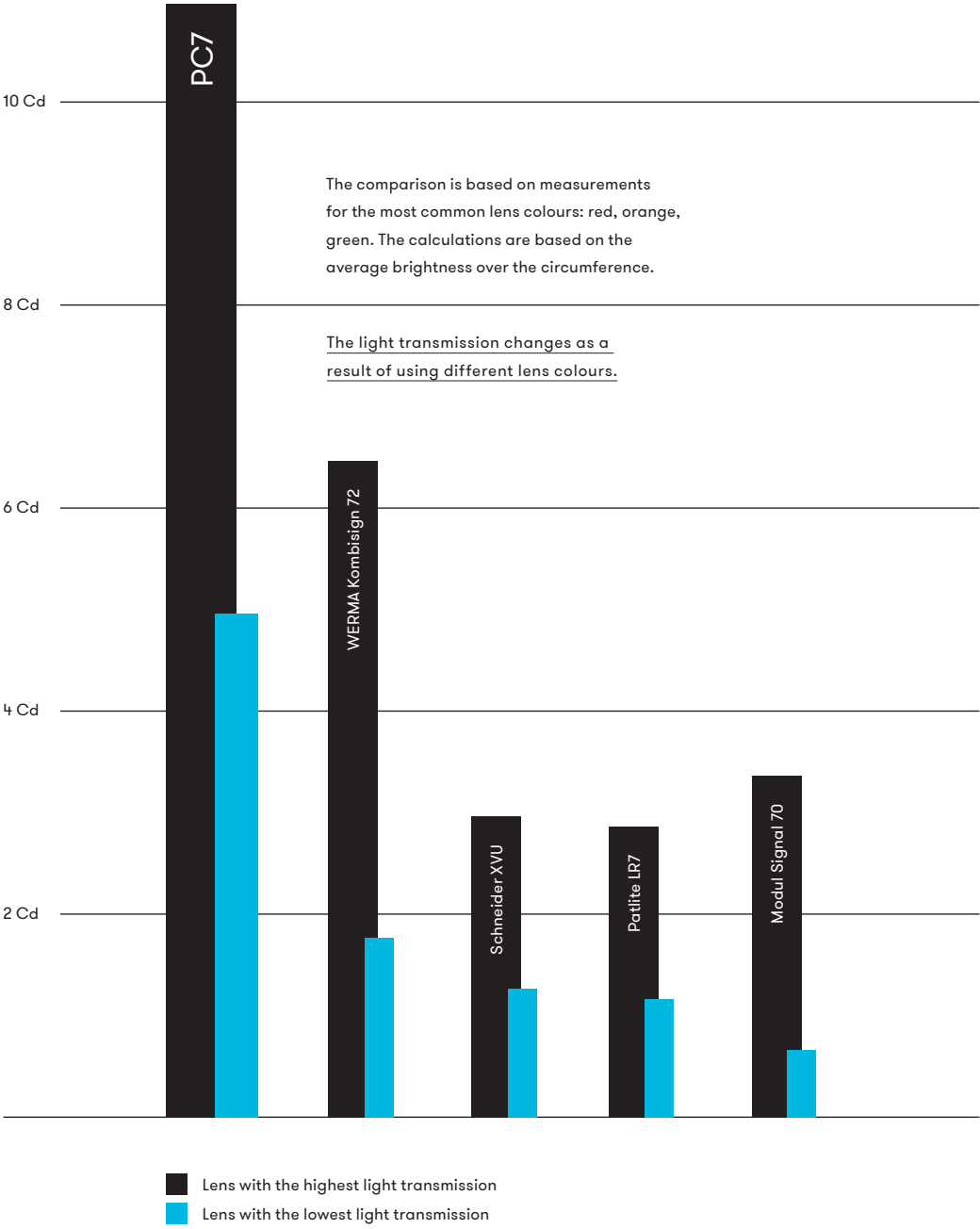

# The tallest Signal Tower

7 positions possible

The unique, patented contacting enables up to 7 positions thanks to 8 inner contacts. As a result, the PC7 is not only the tallest signal tower, but also the one that offers the most combination options. This makes it future-proof and equipped for any application.



8 contacts provide a  
wide variety of options



Different individual modules require different numbers of contacts. The new inner contacting offers 8 contacts, which enable a total of 7 positions. This makes challenging, visual-audible tower variants feasible. The unique and patented inner contacting also enhances the visual appearance of the PC7, as the externally visible contacting wires that were previously used are no longer required.

# The perfect LED light modules

A higher level of brightness,  
a top module and completely  
new functions

## **MULTI FUNCTION MODULE**

Steady light, flashing light, strobe light  
and double strobe light

## **ROTATING LIGHT MODULE**

2 rotation speeds – 90 and 180 rpm

## **MULTI COLOUR MODULE**

7 colours can be switched externally (red,  
yellow, green, blue, clear, magenta and turquoise)

## **STEADY LIGHT BEACON MODULE**

First choice for standard applications  
where price is a key priority



Thanks to lenses on the circuit  
board, which concentrate the  
light, the PC7 achieves a higher  
level brightness with no increase  
in energy consumption.

## The new top module



The top module not only provides brighter light than the individual light modules in a 360° horizontal plane, it can also provide 180° hemispherical lighting at the top or bottom. This ensures that the tower is clearly visible at different heights.

## The perfect tone modules

Inline-enabled multi-tone module, multi-tone alarm sounder module for the best possible sound quality and an innovative MP3/voice output module



### **PC7TD**

Top multi-tone alarm sounder module



### **PC7ZI**

Multi-tone module



### **PC7VS**

Top MP3/voice output module



### **PC7ZM**

Top multi-tone module

### **MULTI-TONE MODULE**

Previously, the tone module was always at the top of a signal tower. The new inline tone module of the PC7 can be placed in any position within the tower.

### **MULTI-TONE ALARM SOUNDER MODULE**

By using a sound capsule, the multi-tone alarm sounder module offers significantly better tone

quality than the multi-tone module. 7 different signal tones can be activated externally from a range of 80 via 3 inputs.

### **MP3/VOICE OUTPUT MODULE**

The MP3/voice output module allows you to select and play up to 7 different voice messages or melodies.



## Diffusor



Without altering the signalling effect too greatly, you can choose between a clear or a diffuse signal tower appearance with our new diffuser films. The diffuser films are available as accessories and can be effortlessly placed in each individual module, even at a later point. This allows the PC7 to provide a single tower with two appearances – to suit whatever your preferences are.

One module,  
two appearances

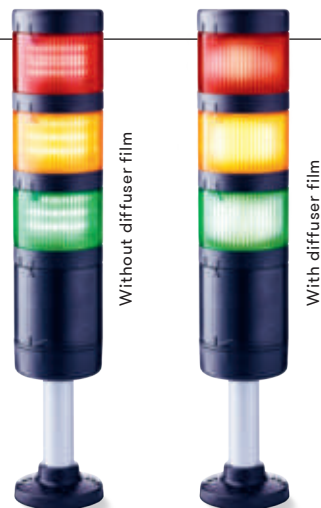

## Plug & play

The new, cost-effective  
M12 connector base



This M12 connector base is the perfect solution for applications where quick, easy and cost-effective installation of the signal tower is a key priority.

Easy connection to  
bus and digital networks

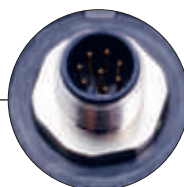

8-pin connector



5-pin connector

## A collection of various industrial safety lights and sirens, including rotating beacon lights in orange, yellow, and red, and large red and orange sirens, displayed on a white background.

From high-end equipment to affordable products with great performance

Cubic design  
in 4 sizes



## Series A+Q

the Mighty &  
the Bright



The most extensive range of products for cubic-design multi-tone alarm sounders and cubic-design beacons in LED and xenon technology. Perfect for industrial applications, in process technology and for use in the navy.

## FEATURES

- Largest comprehensive series, cubic design in four sizes
- Sounders with sound pressure of 90 to 127 dB, infinitely adjustable
- Steady, flashing, strobe and multi-strobe beacons in LED or xenon technology
- High luminous intensity up to 400 candela thanks to high-power LED
- Frontal and lateral signalling effect thanks to unique lens design
- Available in six different lens colours
- Highly impact-resistant polycarbonate lens, UV-stabilised
- Up to 63 tones can be selected, three tones can be switched externally
- Internationally standardised signal tones
- Cost-effective combinations with light and buzzer indicators
- Certified according to the most stringent international standards
- High degree of protection IP66
- High degree of impact resistance IK09



### MULTI-TONE SOUNDER A

Size 1 ASS-P  
ASS-T

Size 2 ASM

Size 3 ASL

Size 4 ASX

### + BEACON M22

### = COMBINATION A+M22

Size 1 ADS-P LED Steady beacon  
ADS-T LED Steady/flashing beacon

Size 2 ADM LED Steady/flashing beacon  
ACM LED Multi-strobe beacon

Size 3 ADL LED Steady/flashing beacon  
ACL LED Multi-strobe beacon

Size 4 ADX LED Steady/flashing beacon  
ACX LED Multi-strobe beacon



#### BEACON Q

Size 1 QDS LED Steady/flashing beacon  
QBS LED Multi-strobe beacon  
QFS Xenon strobe beacon

Size 2 QDM LED Steady/flashing beacon  
QBM LED Multi-strobe beacon  
QFM Xenon strobe beacon

Size 3 QDL LED Steady/flashing beacon  
QBL LED Multi-strobe beacon

Size 4 QDX LED Steady/flashing beacon  
QBX LED Multi-strobe beacon

#### + BUZZER M22

#### = COMBINATION Q+M22

Size 1 QSS LED Steady/flashing beacon  
QCS LED Multi-strobe beacon  
QTS Xenon strobe beacon

Size 2 QSM LED Steady/flashing beacon  
QCM LED Multi-strobe beacon  
QTM Xenon strobe beacon

Size 3 QSL LED Steady/flashing beacon  
QCL LED Multi-strobe beacon

Size 4 QSX LED Steady/flashing beacon  
QCX LED Multi-strobe beacon



#### **MULTI-TONE SOUNDER A**

Size 1	ASS-P
	ASS-T

Size 2	ASM
--------	-----

Size 3	ASL
--------	-----

Size 4	ASX
--------	-----

#### **+ BEACON Q**

Size 1	QDS LED Steady/flashing beacon QBS LED Multi-strobe beacon QFS Xenon strobe beacon
--------	--

Size 2	QDM LED Steady/flashing beacon QBM LED Multi-strobe beacon QFM Xenon strobe beacon
--------	--

Size 3	QDL LED Steady/flashing beacon QDL LED Multi-strobe beacon
--------	---

Size 4	QDX LED Steady/flashing beacon QBX LED Multi-strobe beacon
--------	---

#### **= COMBINATION A+Q**

Size 1	ASS-P + QDS LED Steady/flashing beacon ASS-P + QBS LED Multi-strobe beacon ASS-P + QFS Xenon strobe beacon ASS-T + QDS LED Steady/flashing beacon ASS-T + QBS LED Multi-strobe beacon ASS-T + QFS Xenon strobe beacon
--------	--

Size 2	ASM + QDM LED Steady/flashing beacon ASM + QBM LED Multi-strobe beacon ASM + QFM Xenon strobe beacon
--------	--

Size 3	ASL + QDL LED Steady/flashing beacon ASL + QBL LED Multi-strobe beacon
--------	---

Size 4	ASX + QDX LED Steady/flashing beacon ASX + QBX LED Multi-strobe beacon
--------	---

Modular signalling equipment series  
for universal applications with high  
degree of protection IP67

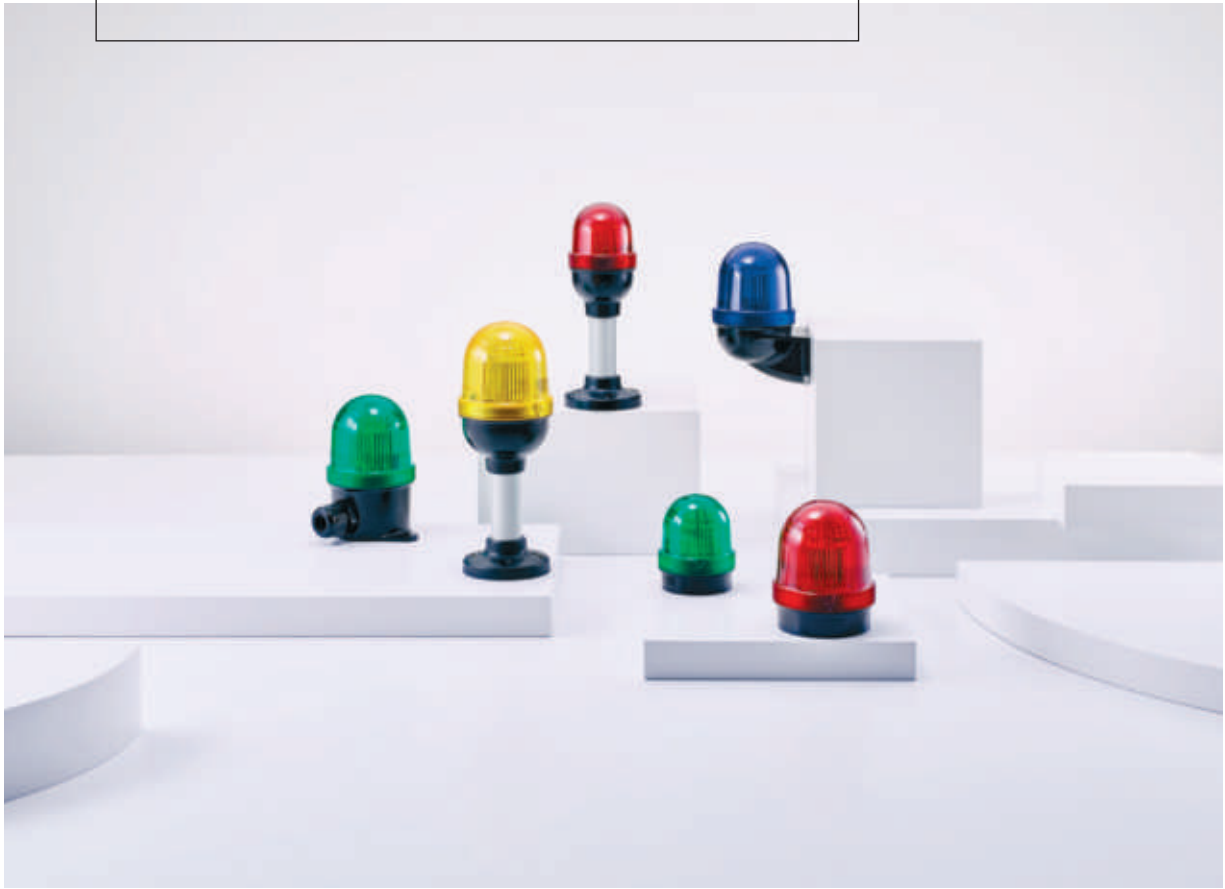

## Series T+U

the Allrounder



Extensive and modular signalling equipment series in two sizes –  
Ø 60 mm and Ø 75 mm – for universal applications. Suitable for use  
during extreme variations in temperature. Beacon in combination  
with buzzer module with high degree of protection IP66.

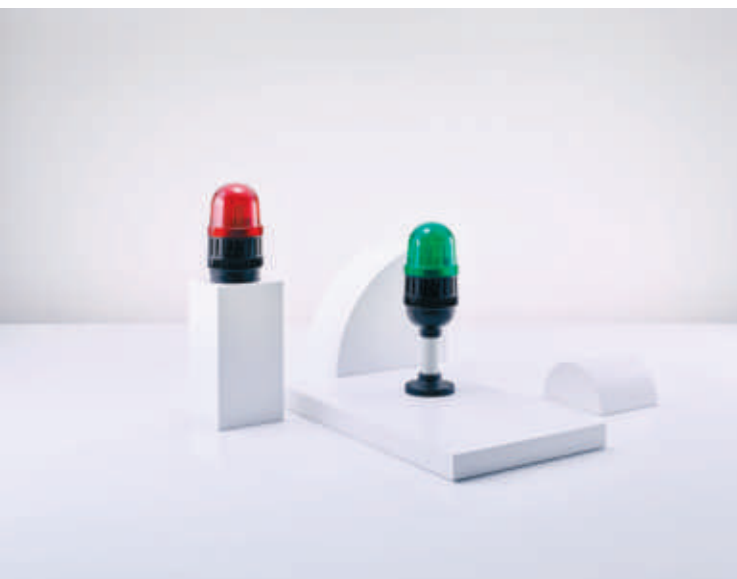

#### ADDITIONAL INFORMATION FOR PANEL-MOUNT BEACONS

- Panel size Ø 37 mm
- Tamper-proof and vandal-proof design, anti-twist mechanism
- Highest degree of impact resistance IK10
- Bulb easy to change via bayonet insert (incandescent bulb models)

#### FEATURES

- Modular surface-mount beacons
- Vandal-proof panel-mount beacons
- Two sizes: T series: Ø 75 mm, U series: Ø 60 mm
- LED: Steady, flashing and multi-strobe beacon
- Light functions can be selected via terminal assignment
- Sound pressure adjustable up to 100 dB, steady or pulsing tone
- Light and tone are separately switchable
- Available in six different lens colours
- Seven different types of mounting – quick and straightforward
- Ventilation element available for pressure equalisation during extreme environmental conditions (humidity, strong temperature fluctuations, etc.)
- Suitable for PLC applications (leakage/inrush current)
- Certified according to the most stringent international standards (UL, EAC)
- High degree of protection IP66
- High degree of impact resistance IKo8

#### SURFACE-MOUNT (SERIES T)

TDC	Ø 75 mm, LED steady/flashing beacon
TDF	Ø 75 mm, LED multi-strobe beacon
TLL	Ø 75 mm, steady beacon (Incandescent bulb)

#### BUZZER (SERIES T)

TDE

#### SURFACE-MOUNT (SERIES U)

UDC	Ø 60 mm, LED steady/flashing beacon
UDF	Ø 60 mm, LED multi-strobe beacon
ULL	Ø 60 mm, steady beacon (Incandescent bulb)

#### PANEL-MOUNT (SERIES T)

TDCP	Ø 75 mm, LED steady/flashing beacon
TDFP	Ø 75 mm, LED multi-strobe beacon
TLLP	Ø 75 mm, steady beacon (Incandescent bulb)

#### PANEL-MOUNT (SERIES U)

UDCP	Ø 60 mm, LED steady/flashing beacon
UDFP	Ø 60 mm, LED multi-strobe beacon
ULLP	Ø 60 mm, steady beacon (Incandescent bulb)





## Series N+M

the Performer &  
the Huge

Largest rotating mirror  
beacon on the market

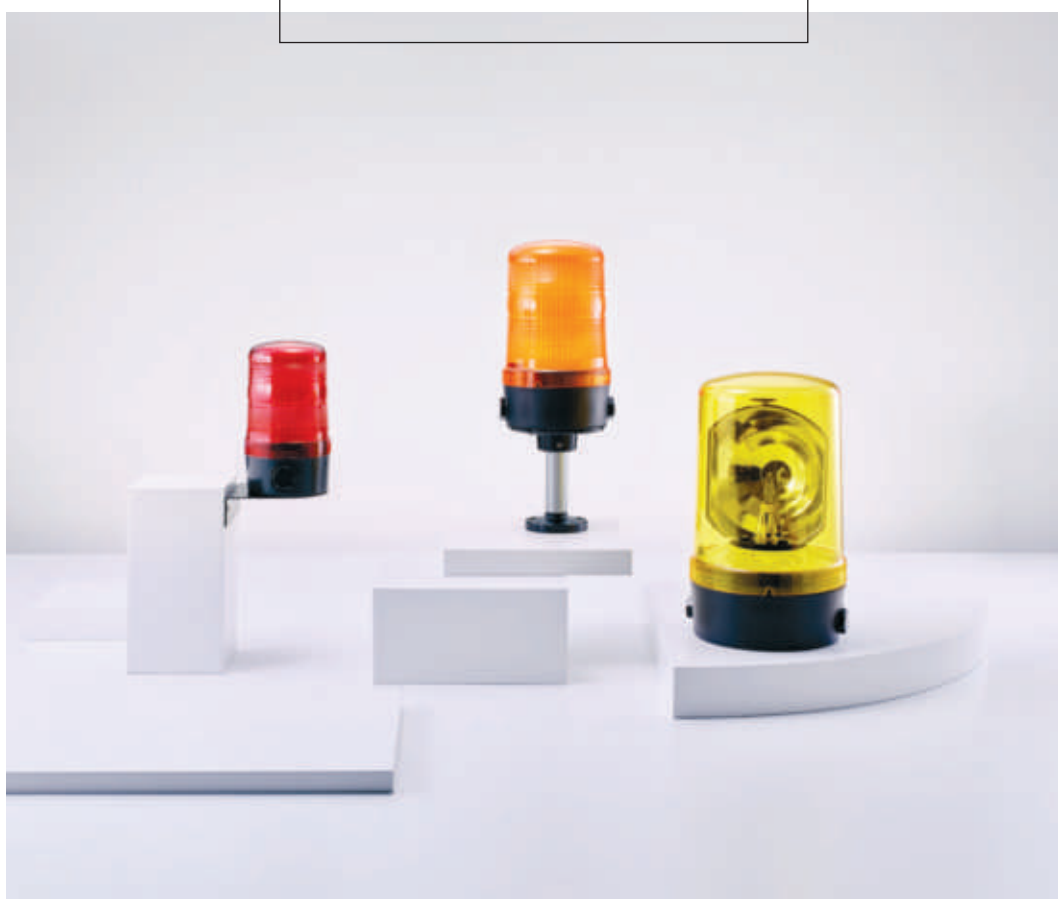

The N series includes the most extensive range of high-quality LED technology. It is available as an LED multi-colour beacon and LED steady/flashing/strobe and multi-strobe beacons. With its high-power LEDs, the series is also suitable for use in extreme light conditions.



#### N SERIES SPECIFICATIONS

- LED beacons: Steady, flashing, strobe, multi-strobe beacon and multi-colour beacon in size Ø 90 mm
- Best signalling effect thanks to high-power LED
- Optimal signalling effect even in extreme light conditions
- Light distribution in all directions
- Specially for outdoor use, clearly visible signalling effect even in sunlight
- High degree of protection: IP65 and IP67

#### M SERIES SPECIFICATIONS

- Powerful, large signal beacon in three sizes: Ø 90 mm, Ø 120 mm and Ø 160 mm
- Rotating mirror models with high operating safety thanks to synthetic bearings
- Speed control of 90 and 180 rpm, speed control with photodiode
- Convenient electrical connection with removable plug-in terminal
- Cable entry with grommet or laterally with a cable gland
- High degree of protection IP65
- Strobe energy up to 30 J

#### FEATURES

- Available in six different lens colours
- Highly impact-resistant polycarbonate lens and housing, UV-stabilised
- Certified according to the most stringent international standards
- PLC-suitable (leakage/inrush current)
- Extensive range of accessories (e.g. for wall mounting, pipe mounting, magnetic fixing, etc.)

#### SERIES N

Ø 90 mm

LED steady/flashing beacon	NES
LED strobe-/double-strobe beacon	NFS
LED multi-strobe beacon HP	NFS-HP
LED multi-colour steady/flashing beacon red-yellow-green	NMS
LED Multi-colour steady beacon red-yellow-green	NMS-HP

#### SERIES M

Ø 90 mm    Ø 120 mm    Ø 160 mm

Xenon strobe beacon	MFS	MFM	MFL
Rotating mirror beacon	MRS	MRM	MRL
Flashing beacon	MBS	MBM	MBL
Steady beacon	MLS	MLM	MLL

# Series G

the Price/Performance Winner

Surface-mounted  
beacon series with Ø  
120 mm and low lens



Our price-performance winner for universal applications. Large signal beacon with good frontal and lateral signalling effect.

## FEATURES

- Surface-mounted beacon series with Ø 120 mm and low lens
- Attractive price-performance ratio
- Very good signalling effect from 48 LEDs
- Choice of xenon strobe beacon and steady beacon or flashing beacon with 25 W
- Available in six different lens colours
- Suitable for PLC applications (leakage/inrush current)
- High degree of protection IP65 for outdoor applications

	Ø 120 mm
LED steady beacon	DLG
LED flashing beacon	BLG
Xenon strobe beacon	FLG
Steady beacon (Incandescent bulb)	WLG
Flashing beacon (Incandescent bulb)	BKG

**HTG**

Signal horn with high degree of protection IP65, die-cast aluminium housing, epoxy powder-coated, max. 108 dB sound pressure

**HPT**

Signal horn with high degree of protection IP65, impact-resistant ABS plastic housing, max. 108 dB sound pressure

**KLH | KDH**

With or without cone 92 dB sound pressure, ABS plastic housing



## Series K+H the Little & the Great Loud

Well-designed and robust electromechanical signal horns with the distinctive, classic horn tone with an attractive price-performance ratio.

**FEATURES**

- Proven electromechanical technology with typical horn tones
- Good price-performance ratio
- All the important nominal voltages are available
- Robust, timeless design

**KLF | KDF**

Combination of mini horn with strobe beacon in xenon technology with or without cone, max. 92 dB sound pressure, ABS plastic housing

**KLL | KDL**

Combination of mini horn with signal beacon in LED steady or flashing light technology or conventional incandescent bulb with or without cone, max. 92 dB sound pressure, ABS plastic housing

The most extensive and  
loudest M22 panel-mount series



## Series M22

the Loudest & Brightest  
Installable

The most extensive M22 panel-mount signalling  
equipment series in three sizes. With the loudest  
panel-mount buzzer available on the market.



<b>PANEL-MOUNT BUZZER</b>	Ø 30 mm	Ø 45 mm	Ø 65 mm
3 tones, max. 105 dB, adjustable			ESG
2 tones, max. 100 dB, adjustable		ESM	
2 tones, max. 85 dB	ESV		
2 tones, max. 65 dB	ESK		

<b>PANEL-MOUNT BEACONS</b>	Ø 30 mm	Ø 45 mm	Ø 65 mm
LED Steady/flashing beacon	IBS	IBM	IBL
LED Strobe-/multi-strobe beacon	ISS	ICM	ICL
Xenon strobe beacon		ISM	ISL
LED Multi-colour steady beacon red-green	IDS	IDM	IDL
LED Multi-colour steady beacon red-green, two-part lens	ITS	ITM	ITL
LED Multi-colour steady beacon red-yellow-green		IMM	IML

### FEATURES

- The most extensive M22 panel-mount signalling equipment series on the market
- Three sizes: Ø 30 mm, Ø 45 mm and Ø 65 mm
- Good brightness and frontal and lateral signalling effect
- Available in six different lens colours
- Highly impact-resistant polycarbonate lens and housing, UV-stabilised
- Long-lasting, resistant to vibrations and with low power consumption
- Visual-audible combinations with piezo and LED technology
- High sound pressure, infinitely adjustable for the most part
- Synchronised tone and light, or separately switchable
- Buzzer models with a wide voltage range: from 8–24 V AC/DC to 150–260 V AC
- Small mounting depth
- PLC-suitable (leakage/inrush current)
- Certified according to the most stringent international standards
- Can be expanded to M30 mounting diameter with an adapter
- High degree of protection IP65 and IP67 for pre-wired models



# Series M28

## the Sirene Beginner

M28 panel-mount buzzer with a wide voltage range for universal applications and sealed electronics. Best European quality at an attractive price.



Best European quality  
with an attractive  
price-performance ratio

### FEATURES

- Attractive price-performance ratio
- Proven piezo technology
- Wide voltage range
- Available in various tones
- Models with tabs or terminal
- Sealed electronics
- Low current consumption
- Ø 43 mm, 90 dB

ESD	Steady tone, connection via tabs
ESP	Pulsing tone, connection via tabs
ESZ-S	Steady or pulsing tone, connection via tabs
ESZ-K	Steady or pulsing tone, connection with screw terminal
BU2	Pulsing tone, connection via tabs
BU3	Pulsing tone, connection via tabs



Pre-wired signal beacon for  
extreme areas of application

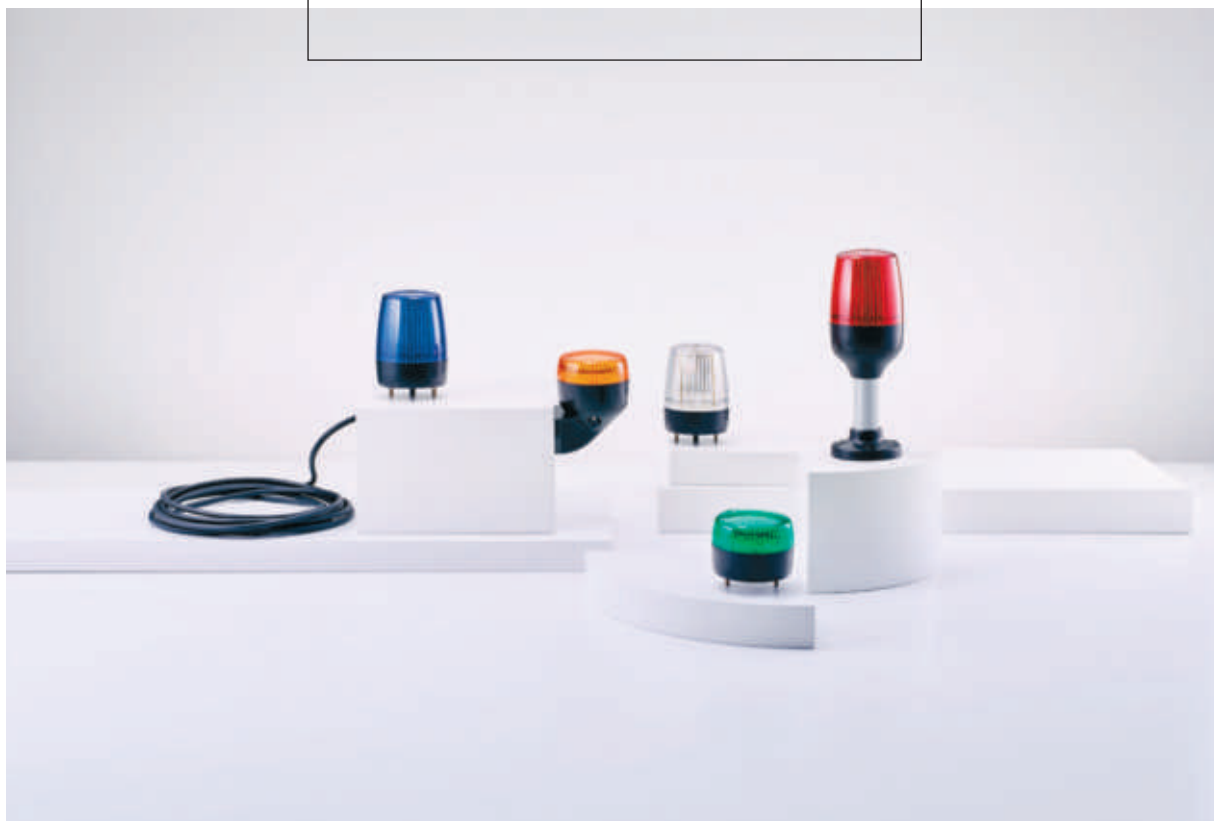

## Series P the Tough

Pre-wired and fully sealed signal beacon with high degree of protection for extreme areas of application in dust, ice, rain and heat. Best signalling effect thanks to modern LED and xenon technology.

### FEATURES

- Surface-mounted beacon series with Ø 75 mm and high degree of protection IP67
- Highly impact-resistant polycarbonate lens and housing, IKo8, UV-stabilised
- Pre-wired as standard, ready to mount with pre-mounted stainless-steel screws
- Modern, bright LED beacon in the following models: Steady, flashing, multi-strobe, multi-colour steady and xenon strobe beacon
- Available in six different lens colours
- Models with high and low lens
- Suitable for PLC applications (leakage/inrush current)
- Accessories for vertical and pipe mounting

### HIGH LENS

PCH	LED steady/flashing beacon
PFH	LED multi-strobe beacon
PMH	LED multi-colour steady beacon
PXH	Xenon flashing beacon

### LOW LENS

PCL	LED steady/flashing beacon
PFL	LED multi-strobe beacon
PXL	Xenon strobe beacon







# Eco-Modul

## the Flexible Allrounder

Modular signal tower  
concept with an excellent  
price- performance ratio

The most modern and flexible all-rounder among the modular signal towers in three sizes: Ø 40 mm, Ø 60 mm and Ø 70 mm. Also available with high-power LEDs for best signalling effect.

### FEATURES

- Modular signal tower in three sizes: Ø 40 mm, Ø 60 mm and Ø 70 mm
- LED beacon modules: Steady, flashing, strobe and multi-strobe beacon
- Also available with high-power LED, alternatively also available with conventional lamps
- Piezo buzzer with adjustable volume and multi-tone alarm sounder modules with up to eight different tones
- Available in six different lens colours
- Made of high-quality impact-resistant and UV-stabilised polycarbonate
- In addition to the 24 V models, variants are also available for the mains voltage
- Extensive range of mounting types, patented quick mounting base
- Also available pre-configured at a cost-effective price
- High contact reliability, even when exposed to vibrations and temperature fluctuations
- Certified according to the most stringent international standards
- High degree of protection IP66



# Modul-Signal

the Proven

Well-proven, modular  
signal tower system

## FEATURES

- Modular signal tower in two sizes:  
Ø 50 mm and Ø 70 mm
- LED steady, flashing, strobe and multi-strobe beacons, xenon strobe beacons or steady/ flashing beacons (incandescent bulb)
- Piezo buzzer with adjustable volume and electronic sounder modules with up to 15 different tones
- Available in six different lens colours
- Made of high-quality impact-resistant and UV-stabilised polycarbonate
- In addition to the 24 V variant, it is also available for direct mains supply
- Many types of mounting, including patented quick mounting system
- Connected to the AS interface fieldbus systems for the Ø 70 mm series
- High degree of protection IP65





# Modul-Compact

## the Readymade



The ready-to-use LED signal tower is offered pre-configured or built to customer specifications and is available in two sizes – Ø 30 mm and Ø 70 mm. Perfect for large quantities. Very attractive price-performance ratio.

### FEATURES

- Pre-configured, ready-to-use and pre-wired LED signal tower
- Two sizes: Ø 30 mm and Ø 70 mm
- Modules available with steady or flashing beacon in six lens colours
- Made of high-quality impact-resistant and UV-stabilised polycarbonate
- One-tone or two-tone modules for steady or pulsing tone
- Many types of mounting, patented quick mounting base
- In addition to the 24 V variant, it is also available for direct mains supply
- High degree of protection IP65

# Half-Dome

## the Design-Tower



Visual-audible LED signal tower in a semi-circular design for wall mounting. Optimal signalling due to 180 degree beam angle.



### FEATURES

- Semi-circular design with 180° beam angle
- Perfect signalling effect from every viewing angle, due to the integrated reflector
- Distinct lens pattern and additional mirroring
- Two to five light modules in six lens colours
- Made of high-quality impact-resistant and UV-stabilised polycarbonate
- Three housing colours: Grey, chrome and black
- Delivered pre-configured or ready to use according to individual customer wishes
- Optional integrated two-tone buzzer (steady and pulsing tone) with adjustable volume
- For 12 V or 24 V control voltage or 115 V or 120 V mains voltage
- Can be used anywhere in the world thanks to international certification
- High degree of protection IP65

# EX signalling devices

Complete range of explosion-proof signalling devices for all industries in which combustible gases, vapours and dusts are created during the production process.



Extensive range of visual and audible explosion-protected signalling devices for use in potentially explosive gas and dust atmospheres classified as Zones 1 and 21. All products offer ignition protection type "e" (increased safety) and can be connected easily and cost-effectively.



## **EXPLOSION-PROOF**

### **SIGNAL BEACONS**

- Available as steady/flashing/strobe/rotating beacons with ignition protection type "d" (flame-proof enclosure) or "m" (encapsulation) for Zone 1, 21
- With LED technology or classic xenon flashing technology
- High degree of protection IP66
- LED multi-colour beacon with 5 signalling colours and 3 signalling modes for Zone 2, 22

### **EXPLOSION-PROOF SIGNAL**

#### **HORNS AND SIGNAL BELLS**

- In ignition protection type "d" (flame-proof enclosure), plastic housing, IP66 degree of protection, for Zone 1
- In ignition protection type "m" (encapsulation), in plastic or metal housings, IP54/66 degree of protection, for Zone 1, 21
- Classic horn tone with electromechanical horn system

### **EXPLOSION-PROOF MULTI-TONE**

#### **ALARM SOUNDERS**

- Multi-tone alarm sounders with 32 signal tones, 2 tones can be switched externally, adjustable volume
- In ignition protection type "d" (flame-proof enclosure), housing made from copper-free seawater-resistant aluminium, for Zone 1, 21
- High degree of protection IP66

### **EXPLOSION-PROOF VISUAL-**

#### **AUDIBLE SIGNALLING SOUNDER**

- Xenon strobe beacon with audible signalling sounder with ignition protection type "m" (encapsulation), for Zone 1
- For universal applications in potentially explosive industrial areas

# Telephones

Complete range of explosion-proof and weather-proof telephones. With analogue and VoIP technology for all kinds of industrial requirements – both offshore and onshore.



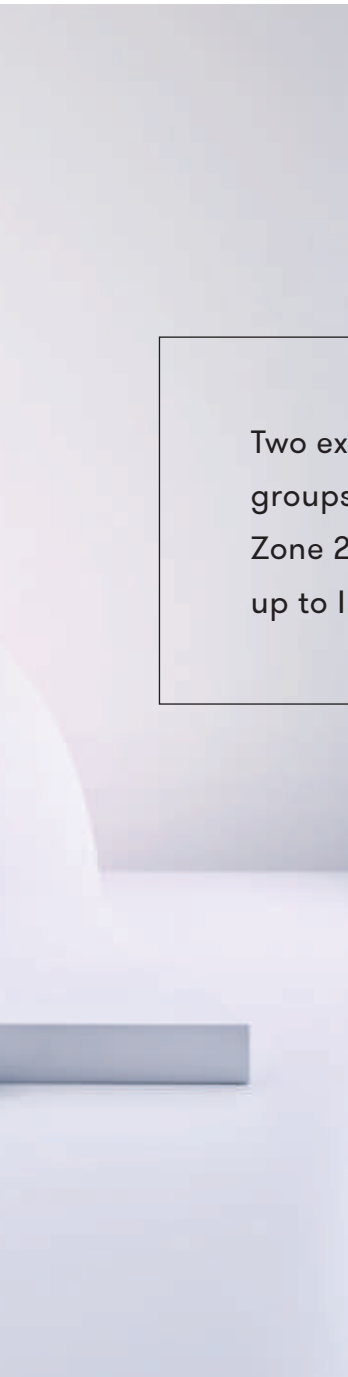

Two explosion-proof telephone groups for Zone 1 and 21 and for Zone 2 and 22. Highly robust with up to IK09 impact protection.

#### **FEATURES**

- Certified for potentially explosive gas and dust atmospheres classified as Zone 1 and 21 or Zone 2 and 22
- High impact protection up to IK09
- Models with analogue and VoIP technology
- Maximum resistance to adverse ambient conditions (humidity, acids, alkalis, temperatures, etc.)
- IP66/IP65 degree of protection
- Extensive range of telephone accessories: audible and visual-audible secondary signalling sounder, headsets and additional earpiece sets, telephone protection hoods, telephone connecting relays



# Auer Signal is one of the world's leading manufacturers of signalling equipment

We are constantly working on new product developments. Through our innovation, foresight and dependability, we have been inspiring our customers since 1910. To ensure we continue to do this into the future, we are approaching our market presence in a similar way to our signalling equipment – making it louder & brighter.

Since 1910, our desire is to develop technical equipment that is a step ahead

Auer Signal is an owner-managed business in its fourth generation and has big ambitions. As a family-run company, trust, dependability and reliability are key values for us.



# Louder & Brighter since 1910.

## **HEADQUARTER**

### **Auer Signal GmbH**

Perfektastrasse 102

1230 Vienna, Austria

T +43 1 813 82 20

F +43 1 815 99 51

[office@auersignal.com](mailto:office@auersignal.com)

[www.auersignal.com](http://www.auersignal.com)

## **SALES GERMANY**

### **Auer Signalgeräte GmbH**

Sperberweg 4g

41468 Neuss, Germany

T +49 2131 29868-60

F +49 2131 29868-66

[info@auersignal.com](mailto:info@auersignal.com)

[www.auersignal.com](http://www.auersignal.com)